

## COMPONENTS SUPPLIED

	Item Code	Description
1	600-0202	3/4" BSP wall flange (& 3 screws)
2	600-0148	500mm M/F extension
3	300-1134	6v 2.5m extension

## INSTRUCTIONS

- Determine height of spout.
- Using a suitable member, fix a cross beam between uprights to use for mounting.
- Mounting surface should be 50-55mm from projected wall surface.
- Mark spout centre and make a hole through member using a 1-1/8" hole saw.
- Unscrew flex hose from 100-0194 spout.
- Mount wall flange to member using supplied screws..
- Thread flex hose and extension cables through all-thread as pictured.
- Make electrical and water connections to cavity space, as pictured.
- Ensure power pack and solenoid are accessible for possible future maintenance.
- Ensure flex and cables can retract into wall cavity when attached to spout.
- After wall covering is complete there should be a maximum of 15mm of all-thread left exposed.

## FIXING THE SPOUT

- Loosen grub screw from spout and remove dress ring - screw dress ring to all-thread.
- Screw flex into rear of outlet, rotating the tap body - not the flex hose.
- Connect the cables exiting the all-thread to the opposite cables in the tap body.
- Slide the tap body over the dress ring, ensuring outlet is correctly aligned, and tighten grub screw.

## TYPICAL INSTALLATION

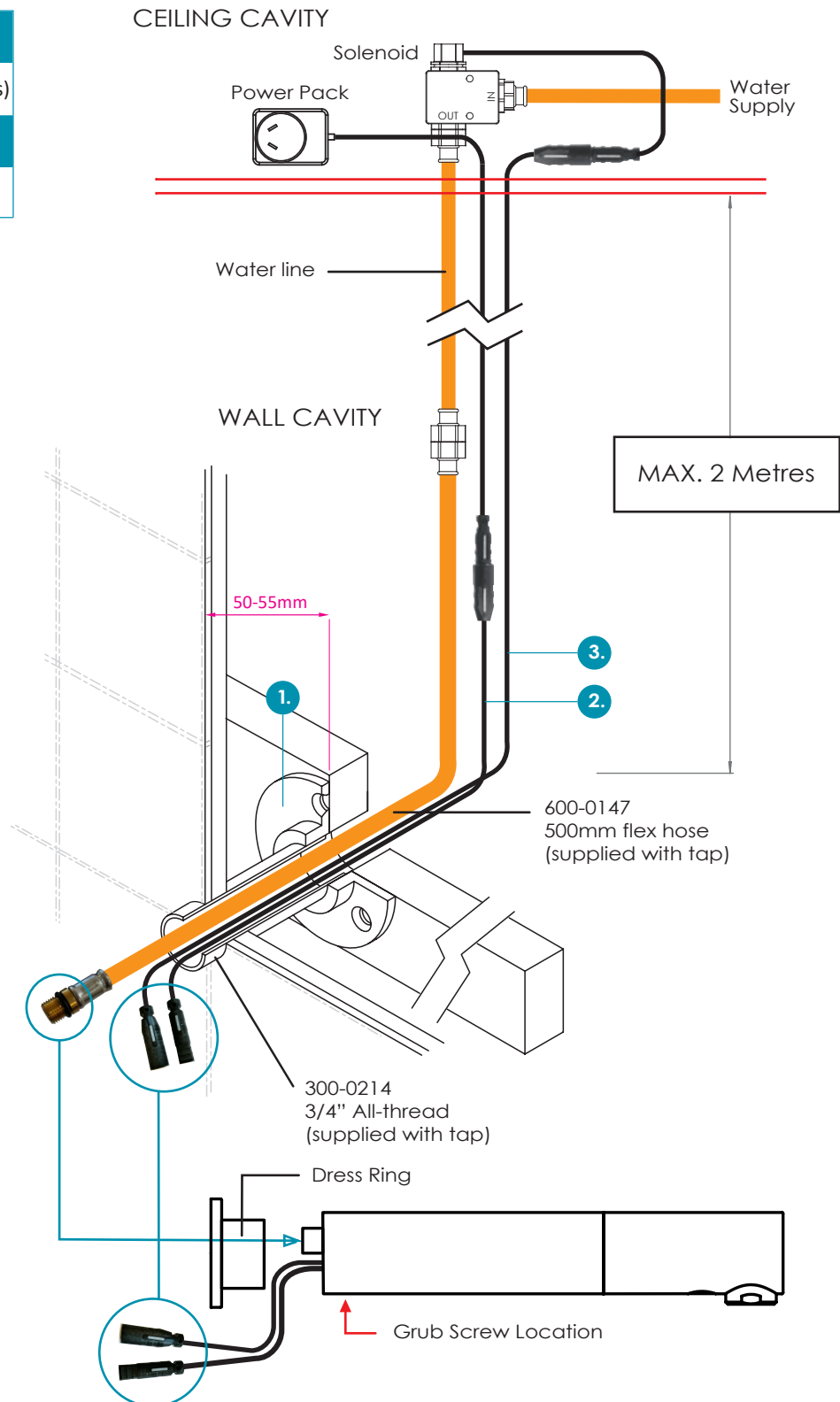

Every effort is made to ensure specifications are correct at the time of printing. Autoflo Pty Ltd reserves the right to make changes without prior notice. Drawing is not to scale.